

## Product Installation guide

**IP20**



For indoor use only



DON'T TOUCH  
THE LED !



25°C

RECOMMENDED ROOM  
TEMPERATURE



MAKE SURE THE POWER  
IS OFF DURING INSTALLATION



120-277V~  
50/60 Hz



RISK OF FIRE AND  
ELECTRICAL SHOCK

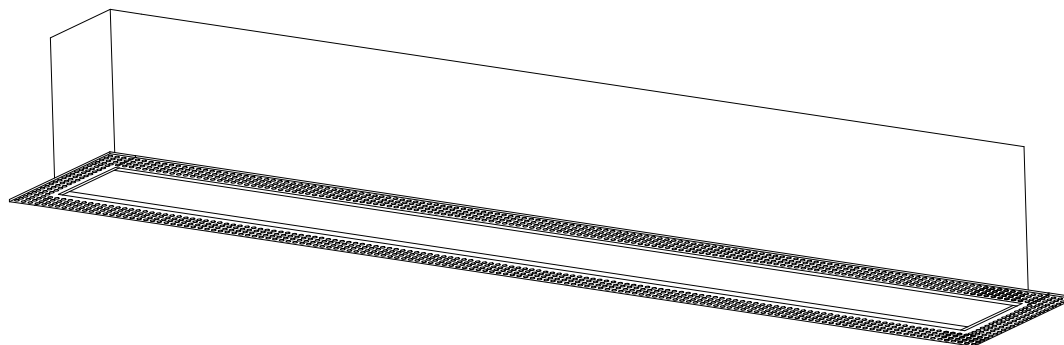
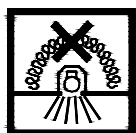

## INSTALLATION INSTRUCTIONS

## DISCLAIMER

Please read all instructions before beginning installation:

1. Turn off electrical power before starting the installation of the light fixture.
2. The feeding voltage must not exceed the specified fixture voltage.
3. This product must be installed by an eligible electrician.
4. Make sure the luminaire is mounted to a secure structure. Mounting the fixture in inappropriate way could lead to serious injury.
5. This luminaire is class 1, it must be earthed in a reliable way.
6. The light source of this luminaire shall only be replaced by the manufacturer, his service agent or a similar qualified person.
7. Wear gloves and safety glasses at all times when removing the luminaire from carton, installing, servicing or performing maintenance
8. Do not install damaged product! This luminaire is properly packed to avoid being damaged during transit. Inspect to confirm before installation. Any damaged or broken part during or after assembly should be replaced.
9. Unauthorized repairs or modifications will void warranty.

### Section View:

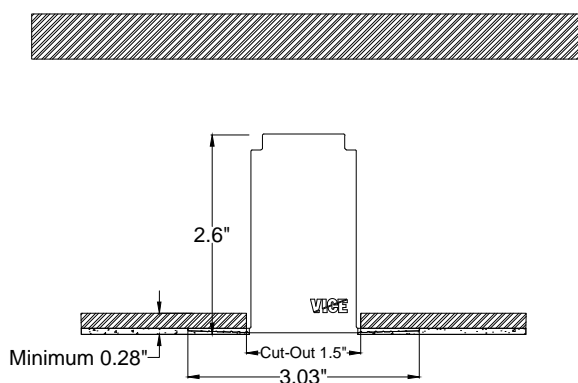

Dimensions in inch

### Applicable optics:

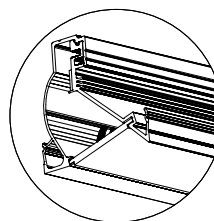

1. CutOff Washer

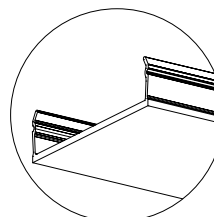

2. Opal & Prismatic

## Product Installation guide

### Dismantling the fixture

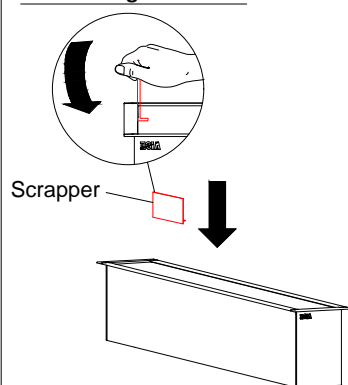

Handle and store the Components in a safe place.

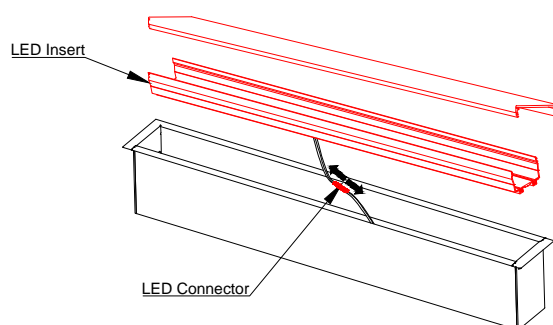

1 Use the scraper to remove the optic.

2 Unclip the LED insert and detach the LED connector.

### Preparing the area



Mains Cable to be provided by the installer

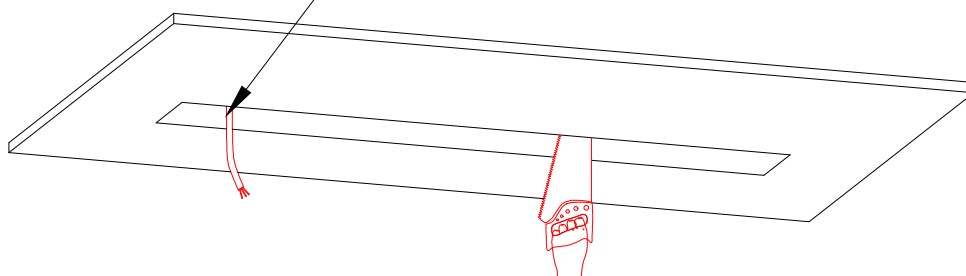

3

- Cut the Ceiling in a rectangular shape respecting the Cut-Out Dimensions(L x 1.5 ").
- Make sure to have access to the Mains cable.

### Fixing the Luminaire

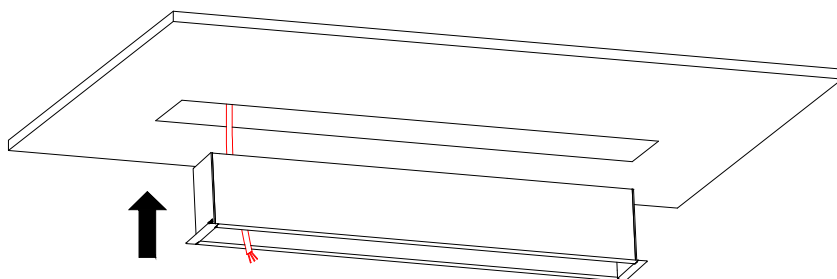

#### Terminal Block Connection

##### Non Dimmable



L - Line  
Earth  
N - Neutral

##### 1-10V & Dali Dimmable

L - Line  
Earth  
N - Neutral



DIM +  
DIM -

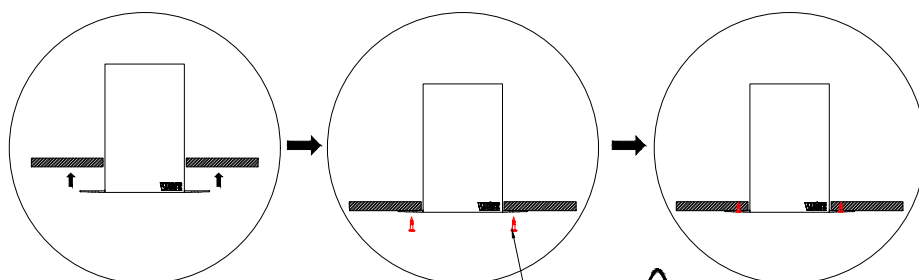

Philips Head Screws to be provided by Installer.

4

- Insert the mains cable
- Lift the profile to the ceiling.
- Screw the trim to the ceiling.
- Connect the wires to the terminal block as shown.

## Product Installation guide

### Plastering the ceiling

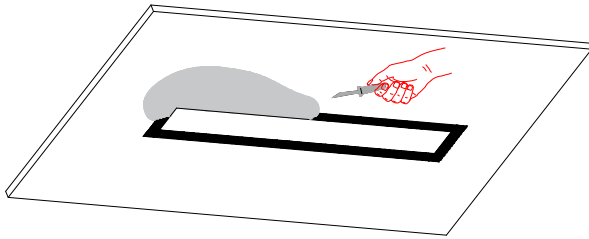

- 5 Plaster the wall using appropriate tools.

### Assembling the Fixture

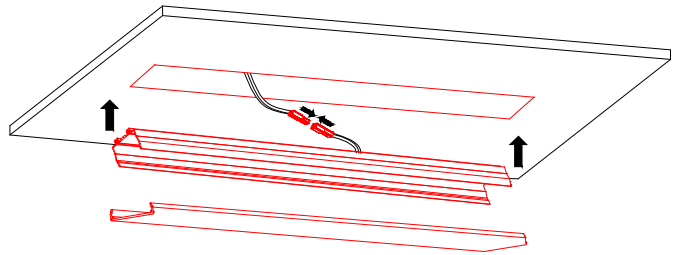

- 6
- Join the LED connector.
  - Clip the LED insert and the optic.

### For continuous Run

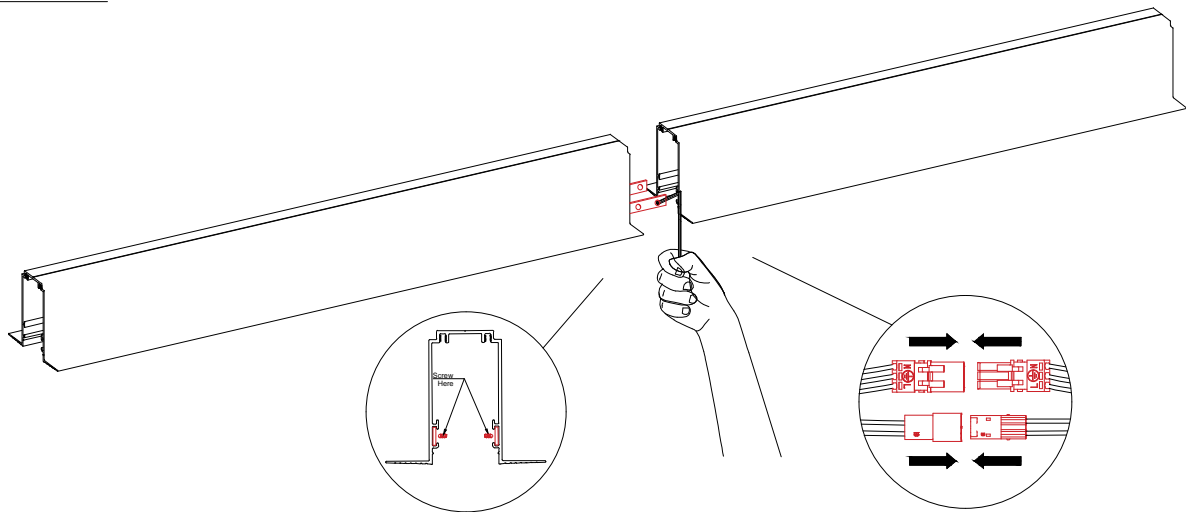

- A
- Fix the first fixture in its position.
  - Install and fix the second fixture next to the first one.
  - Slide the alignment bracket between the two fixtures and screws it.

- B
- Join the electrical /control connectors together.

## Annexe A

\*Code Example:

L3 I RT ----- I 48 I (Individual)  
 L3 I RT ----- I 48 B (Beginning)  
 L3 I RT ----- I 48 M (Middle)  
 L3 I RT ----- I 48 E (End)

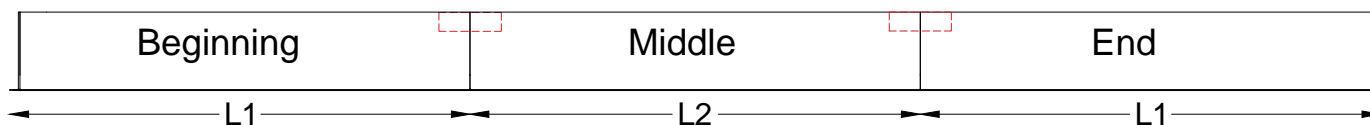
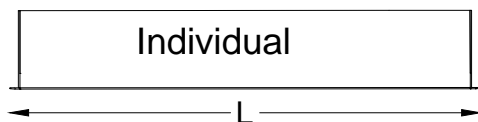

Length Code*	L (inch) (Two End Caps)	L1 (inch) (One End Cap)	L2 (inch) (No End Cap)
12	13.43	12.54	11.65
24	25.00	24.11	23.23
36	36.57	35.69	34.80
48	48.15	47.26	46.38
60	59.72	58.84	57.95
70	71.34	70.45	69.53
82	82.91	82.03	81.10
93	94.49	93.60	92.68
105	106.06	105.18	104.25
116	117.64	116.75	115.83



For the continuous make sure not to exceed 600W on a single feeding input.

\*Code Example: L3 I RT - - - - - I 48 -

## Annexe B

### Asymmetrical optics:

Below section views shows the light direction and the power feeding location for the asymmetrical optic.

CutOff Washer

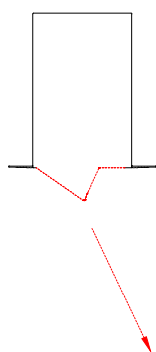

Light Direction

